

Williams Controls

Electronic Floor Pedal, Multi Angle

WM-537

The Electronic Floor Pedal WM-537 is designed for all commercial vehicle applications.

The WM-537 is equipped with a Hall-effect, non-contact sensor that can be programmed for analog output and/or integrated switches. The electronics are IP67 sealed and highly EMI resistant (SAE J1113). In addition, the unit can be customized with contact or PWM output sensors.

The WM-537 is available in three treadle angles: 30, 37.5 and 45 degrees. The base plate has five mounting holes for various mounting options.

This unit is made out of high strength engineered plastics and the treadle is supplied with a rubber cover for improved foot traction.



SPECIFICATIONS

| | | |
|----------------------|---|---|
| PRODUCT LIFE | Full Travel Cycles | 3,000,000 |
| ELECTRONICS | Seal Integrity EMI | Electronics IP67 sealed (IEC 60529) SAE J1113 Compliant |
| ELECTRICAL | Operating Voltage Output Signal | 5V and 12V-24V Dual APS, Dual PWM, APS, PWM, APS/IVS |
| PEDAL ANGLE | Degrees | 30°, 37.5°, 45° |
| MECHANICAL | Static Load Vibration | 1500N 3 hour, 3-axis, random broadband up to 4g |
| ENVIRONMENTAL | Operating Temp Range Storage Temp Range Humidity Sand/Dust | -40°C to 85°C -40°C to 85°C 95% RH for 120 hours, 27°C to 75°C Tested to SAE J1455 |
| MATERIALS | Main Body Mounting Plate Treadle Cover | Composite Plastic Composite Plastic NBR Rubber |

MECHANICAL DIMENSIONS (mm)

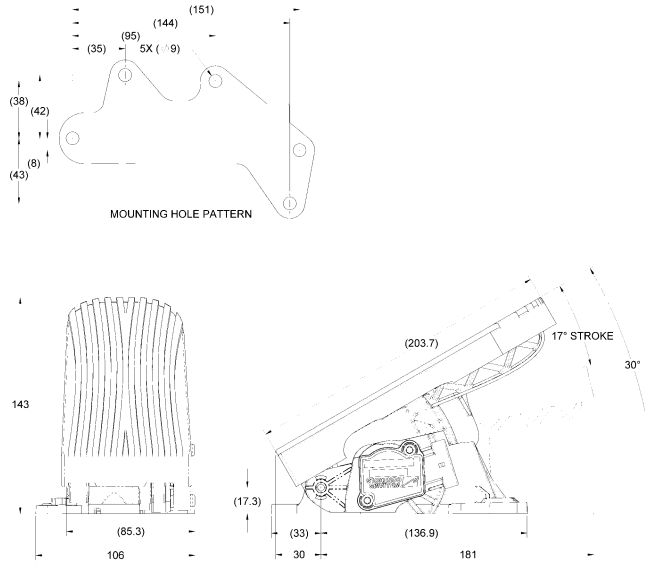

TYPICAL OUTPUT CHARACTERISTICS (other outputs are available)

