

C-Frame Solenoid

GC0828

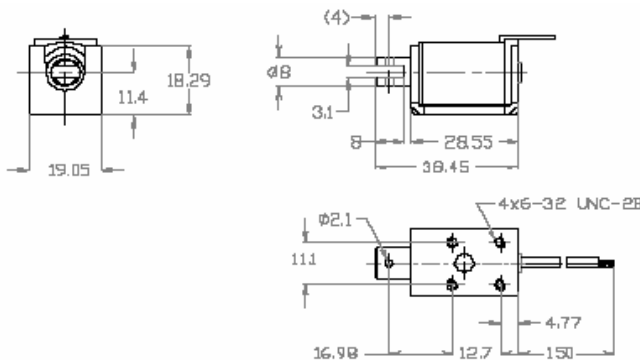

- Pull Type
- Thrust Type
- Flying Leads
- Terminals
- Zinc Plated Frame
- Nickel Plated Plunger
- Customised Plunger Ends
- Customised Fixings
- Optional Voltages



Unit: mm

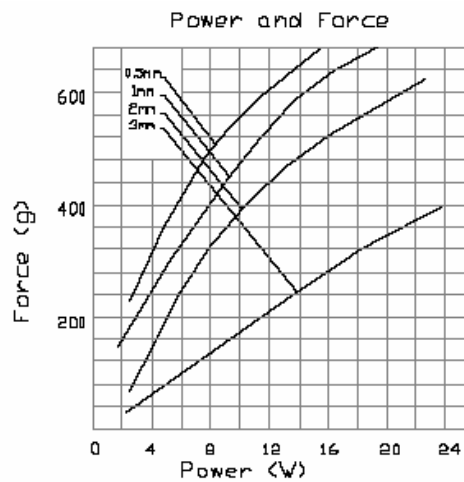
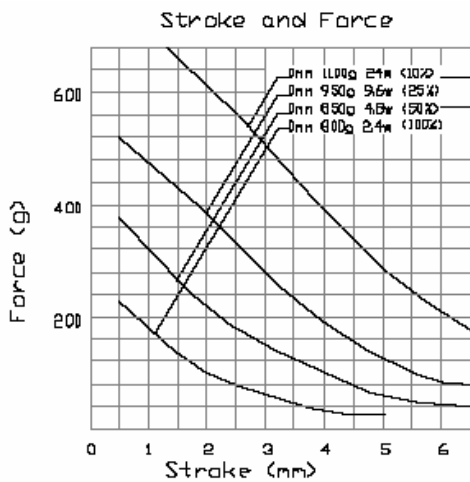

Standard Coil Specifications
Cont. rating(at20°C):2.4w

| Voltage(VDC) | Resistance(Ω) | Current(A) |
|--------------|---------------|------------|
| 6 | 15 | 400 |
| 12 | 60 | 200 |
| 24 | 240 | 100 |
| 48 | 960 | 50 |

Total weight : 45g
Plunger weight : 10g